

05 GOLA HANDLELESS RAIL SYSTEM

05

PRICING

Stocked Base and Wall Profiles	178
Stocked Larder Profiles	179
Stocked Base and Wall Profiles	180
Stocked Larder Profiles	181

TECHNICAL & INSTALLATION GUIDE

Top Rail	182
Mid Rail	184
Larder Rail	188
Single vertical rail	189
Double vertical rail	189
Appliance Filler	190
Wall Rail	192
Matrix	193

GOLA

Stocked Base & Wall Profiles

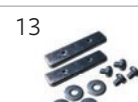
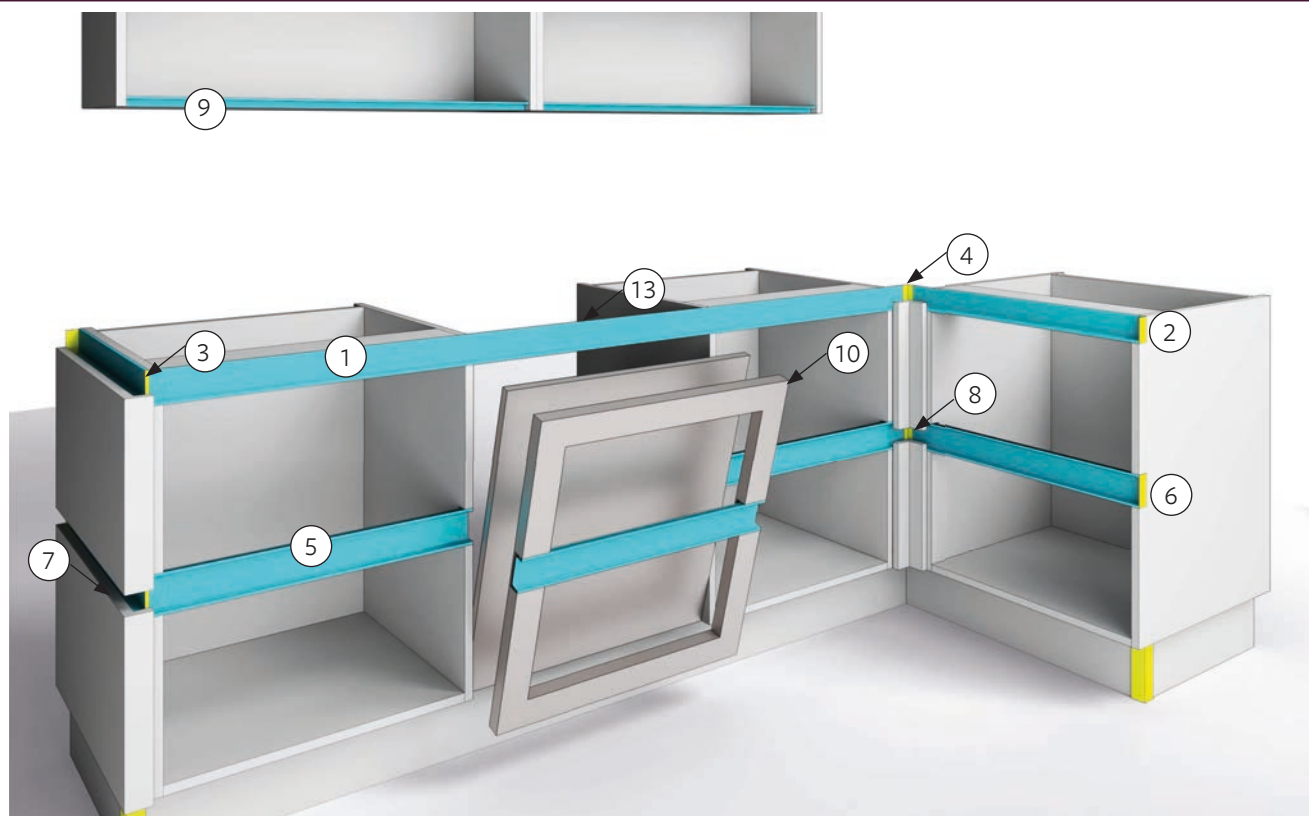

No.	Code	Type	Description	Steel (S)	Black (MB)	Page
1	SGPTHP(X)	Top rail	4100mm rail			4
2	SGPTINTC(X)	Top rail	End caps (1 x LH & 1 x RH)			5
3	SGPTXT90(X)	Top rail	90° external corner connector - Metal			5
4	SGPTINT90(X)	Top rail	90° internal corner connector - Metal			5
5	SGPMHP(X)	Mid rail	4100mm rail			6
6	SGPMINTC(X)	Mid rail	End caps (1 x LH & 1 x RH)			7
7	SGPMEXT90(X)	Mid rail	90° external corner connector - Metal			7
8	SGPMINT90(X)	Mid rail	90° internal corner connector - Metal			7
9	SGPWHP(X)	Wall rail	3900mm rail			14
10	SGPDFS	Fixings	Drawer dishwasher frame			9
11	SGPFIX3	Fixings	Brackets - Screwed. Pairs			N/A
12	SGPFIX2	Fixings	Brackets - Dowelled. Pairs			N/A
13	SGPINLINE	Fixings	In-line fixing connector			N/A

Please note, items 10-13 are not colour matched to the Gola profiles.

GOLA

Stocked Larder Profiles

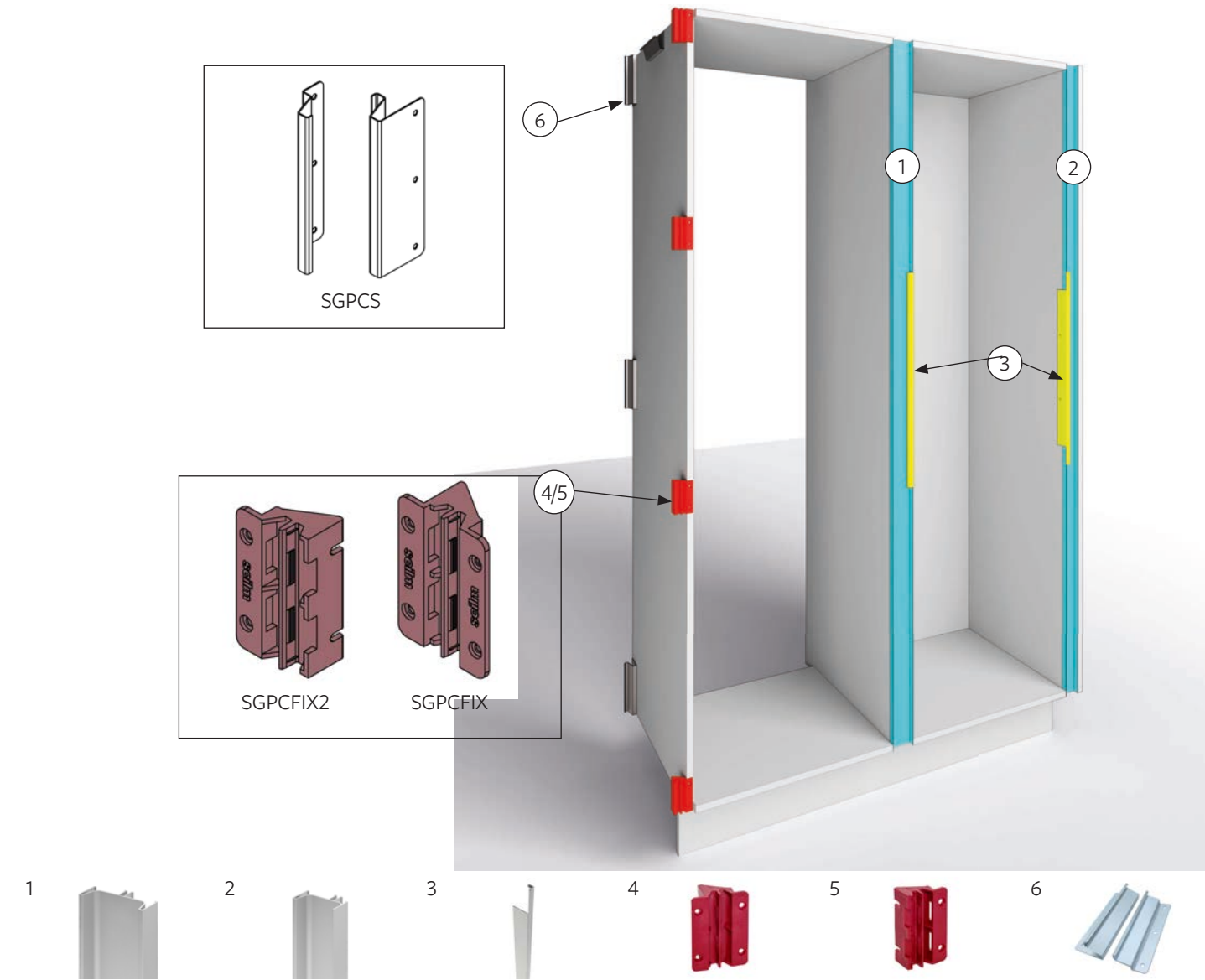

No.	Code	Type	Description	Steel (S)	Black (MB)	Page
1	SGPC2(X)	Vertical rail	4500mm double rail			10
1	SGPC2.2200(X)	Vertical rail	2250mm double rail			10
4	SGPCFIX	Fixing	Fixing plate for double rail. Singles			11
2	SGPC1(X)	Vertical rail	4500mm single rail			10
2	SGPC1.2200(X)	Vertical rail	2250mm single rail			10
5	SGPCFIX2	Fixing	Fixing plate for single rail. Singles			11
6	SGPCS	Fixing	Fixing bracket for side panel/cabinet coupling - single set			11
3	SGPCFILL580(X)	Filler	Appliance filler - 580mm - Single piece			12

Code	Description	Steel (S)	Black (MB)	Page
SGPTHSAMP(X)	Top rail sample			-
SGPMHSAMP(X)	Mid rail sample			-

NOTE

To specify the colour when ordering, please use the suffix listed within the colour in the headings above.

GOLA

Bespoke Painted Base & Wall Profiles

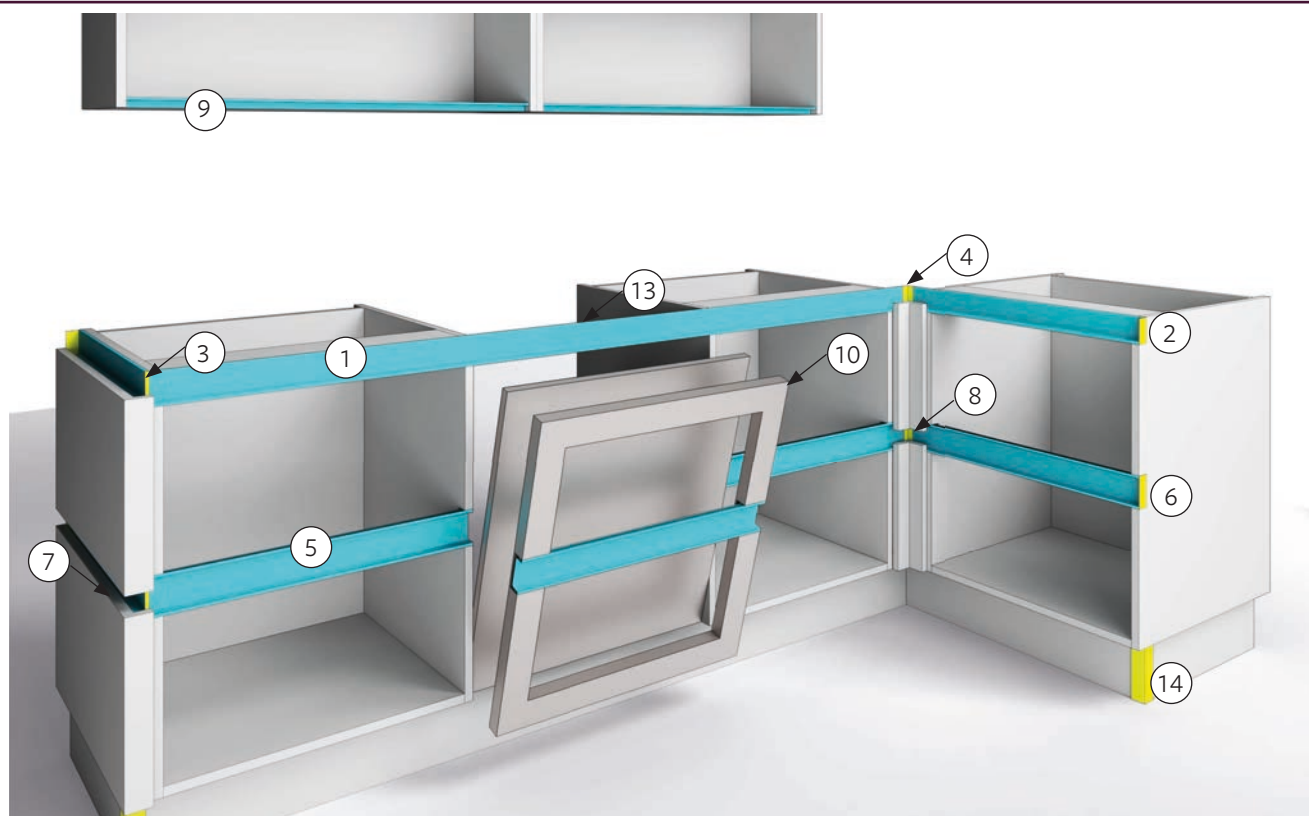

No.	Code	Type	Description	Bespoke	Shimmering	Page
1	SGPTHP(X)	Top rail	3000mm rail			4
2	SGPTINTC(X)	Top rail	End caps (1 x LH & 1 x RH)			5
3	SGPTXT90(X)	Top rail	90° external corner connector - Metal			5
4	SGPTINT90(X)	Top rail	90° internal corner connector - Metal			5
5	SGPMHP(X)	Mid rail	3000mm rail			6
6	SGPMINTC(X)	Mid rail	End caps (1 x LH & 1 x RH)			7
7	SGPMEXT90(X)	Mid rail	90° external corner connector - Metal			7
8	SGPMINT90(X)	Mid rail	90° internal corner connector - Metal			7
9	SGPWHP(X)	Wall rail	3000mm rail			14
10	SGPDFS	Fixings	Drawer dishwasher frame			9
11	SGPFIX3	Fixings	Brackets - Screwed. Pairs			N/A
12	SGPFIX2	Fixings	Brackets - Dowelled. Pairs			N/A
13	SGPINLINE	Fixings	In-line fixing connector			N/A
14	90DCC	Fixings	Plinth connector			N/A

Please note, items 10-13 are not colour matched to the Gola profiles.

GOLA

Bespoke Painted Larder Profiles

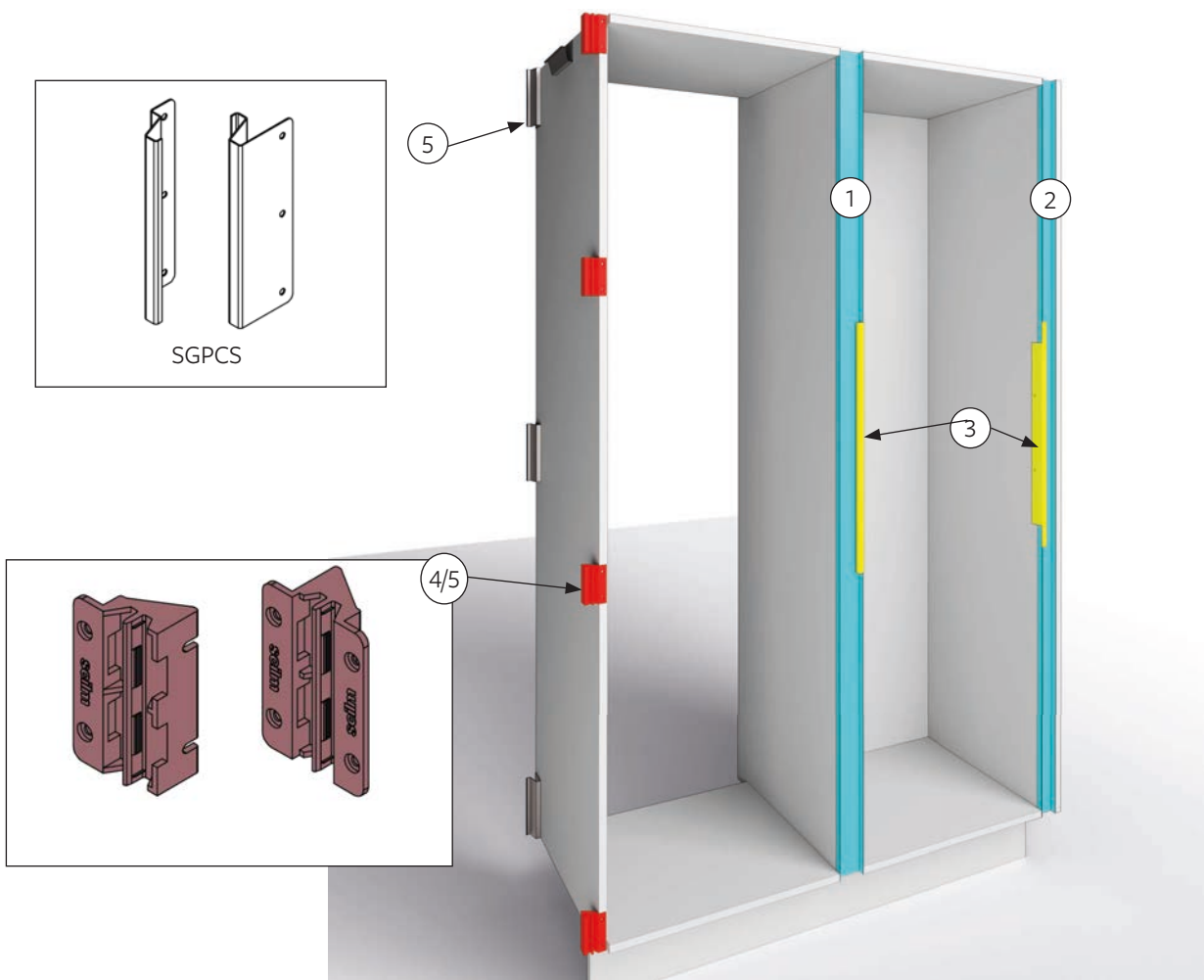

No.	Code	Type	Description	Bespoke	Shimmering	Page
1	SGPC2(X)	Vertical rail	3000mm double rail			10
1	SGPC2.2200(X)	Vertical rail	2250mm double rail			10
4	SGPCFIX	Fixing	Fixing plate for double rail. Singles			11
2	SGPC1(X)	Vertical rail	3000mm single rail			10
2	SGPC1.2200(X)	Vertical rail	2250mm single rail			10
5	SGPCFIX2	Fixing	Fixing plate for single rail. Singles			11
6	SGPCS	Fixing	Fixing bracket for side panel/cabinet coupling - single set			11
3	SGPCFILL580(X)	Filler	Appliance filler - 580mm - Single piece			12

Code	Description	Steel (S)	Black (MB)	Page
SGPTHSAMP(X)	Top rail sample			-
SGPMHSAMP(X)	Mid rail sample			-

GOLA

Top Rail

TOP RAIL OVERVIEW

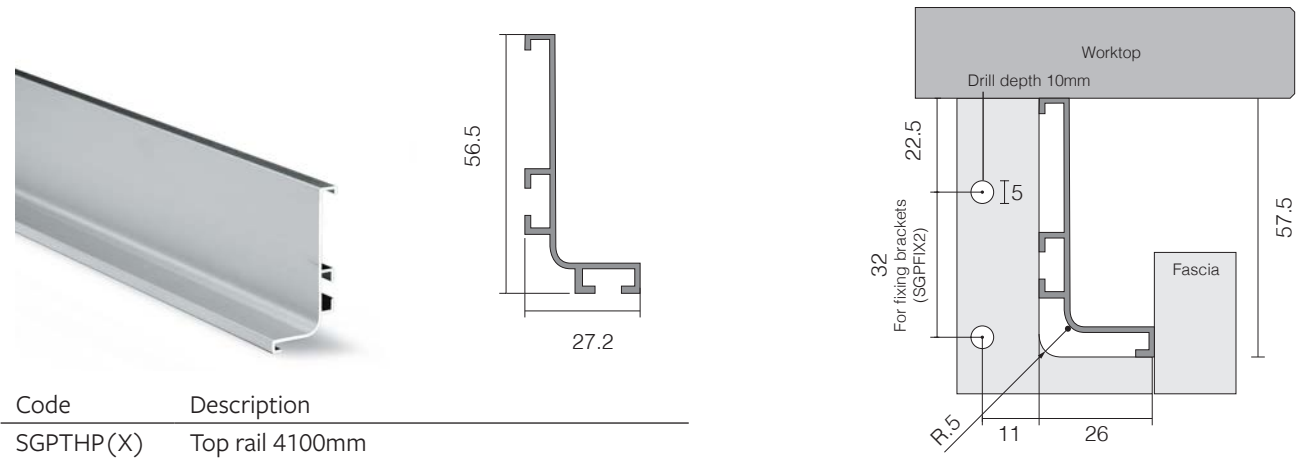

- This product is for base units.
- Secured to cabinets with fixing brackets.
Code: SGPFIX2 or SGPFIX3.
- Can be cut to size with a circular chop saw.

(X) Suffix required to specify colour

CABINET DIMENSIONS

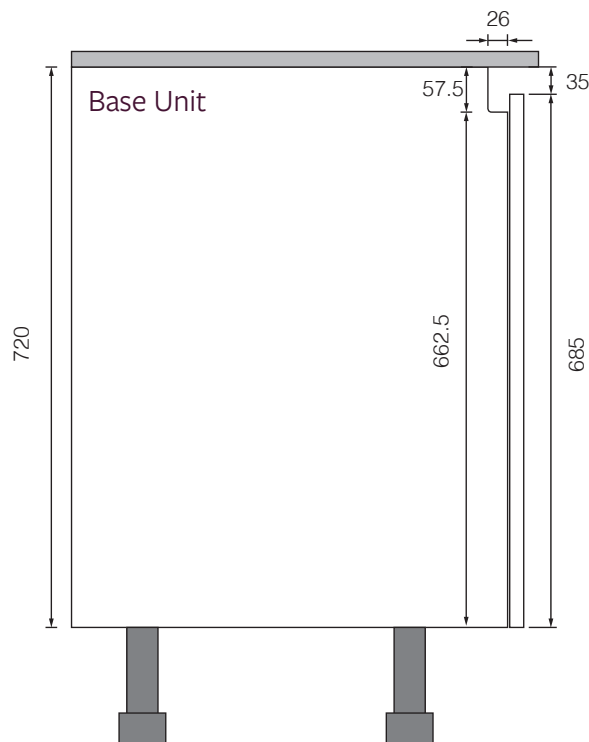

GOLA

Top Rail Accessories

INTERNAL CORNER CONNECTORS

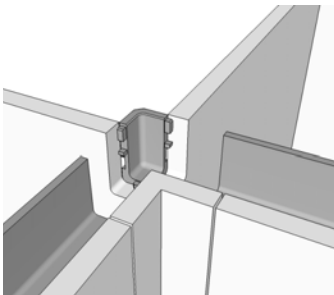
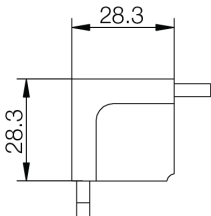

Code	Description
SGPTINT90(X)	90° internal corner connector - Aluminium
Note: This product is to be used with the internal corner post	

EXTERNAL CORNER CONNECTORS

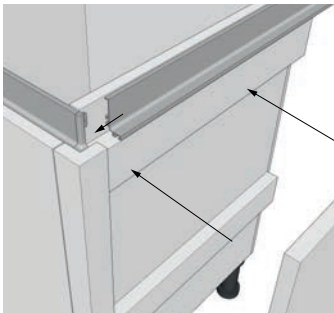
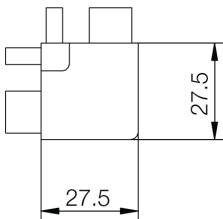

Code	Description
SGPTEXT90(X)	90° external corner connector - Aluminium
Note: This product is to be used with the external corner post	

END CAPS

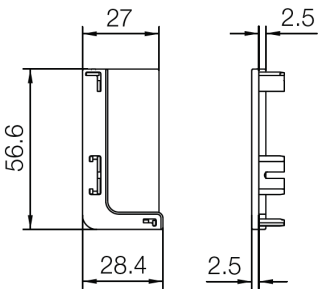

Code	Description
SGPTINTC(X)	End caps - Plastic
Note: This product is to be used to cap top gola rail profiles	

(X) Suffix required to specify colour

GOLA

Mid Rail

MID RAIL OVERVIEW

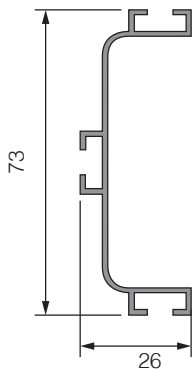

Code	Description
SGPMHP(X)	Mid rail 4100m

- This product is for base units.
- Secured to cabinets with fixing brackets.
Code: SGPFIX2 or SGPFIX3.
- Can be cut to size with a circular chop saw.

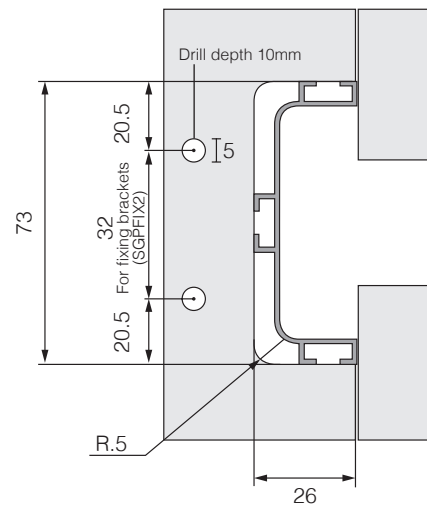

(X) Suffix required to specify colour

CABINET DIMENSIONS

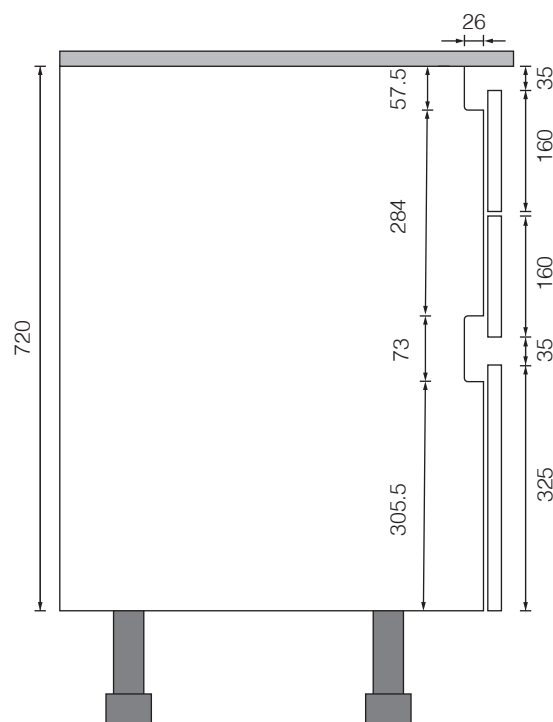
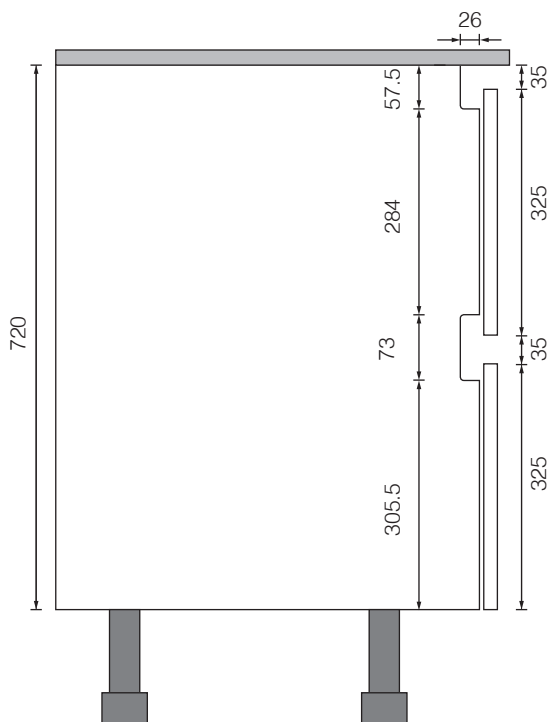

GOLA

Mid Rail Accessories

INTERNAL CORNER CONNECTORS

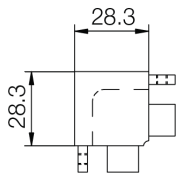

Code	Description
SGPMINT90(X)	90° internal corner connector - Aluminium
Note: This product is to be used with a modified corner post	

EXTERNAL CORNER CONNECTORS

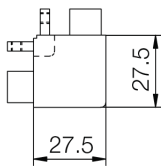

Code	Description
SGPMEXT90(X)	90° external corner connector - Aluminium
Note: This product is to be used with a modified external corner post	

END CAPS

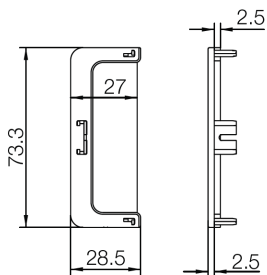
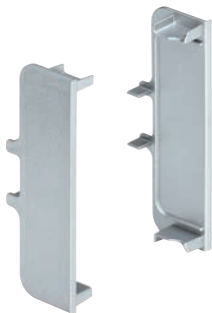

Code	Description
SGPMINTC(X)	End caps - Plastic
Note: This product is to be used to cap gola rail profiles	

(X) Suffix required to specify colour

GOLA

Top/Mid Rail Installation

TOP/MID RAIL INSTALLATION

Step 1

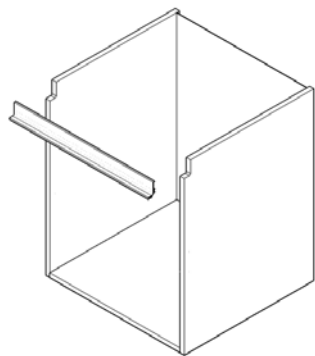

Step 2

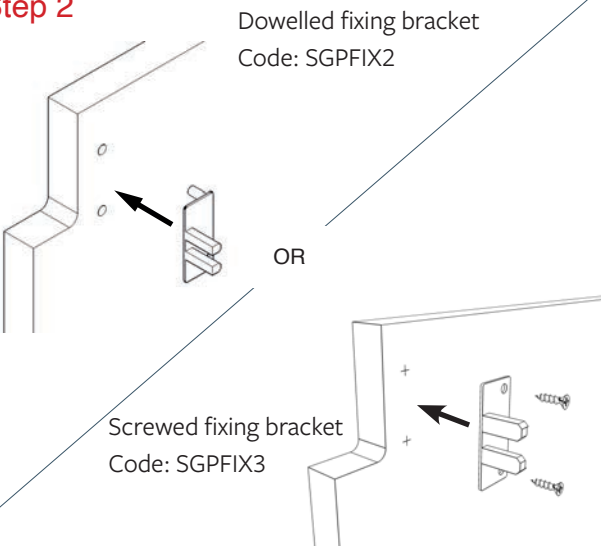

Step 3

Locking device, included with fixing sets

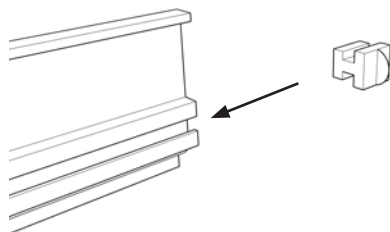

Step 4

Locking device, included with fixing sets

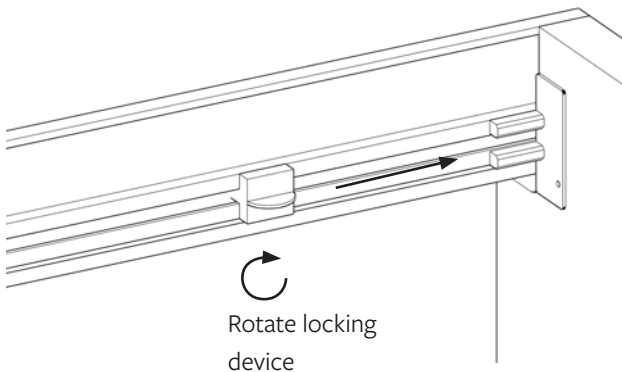

Step 5

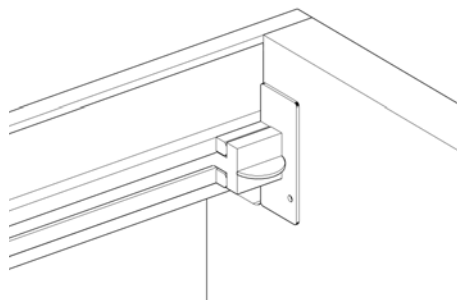

Step 6

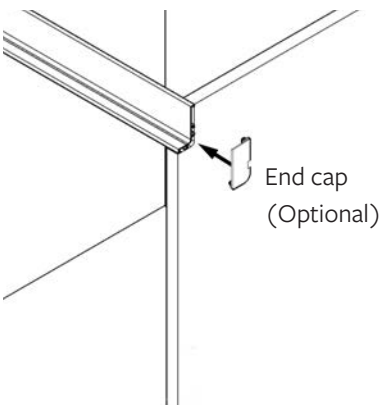

DISHWASHER FRAME

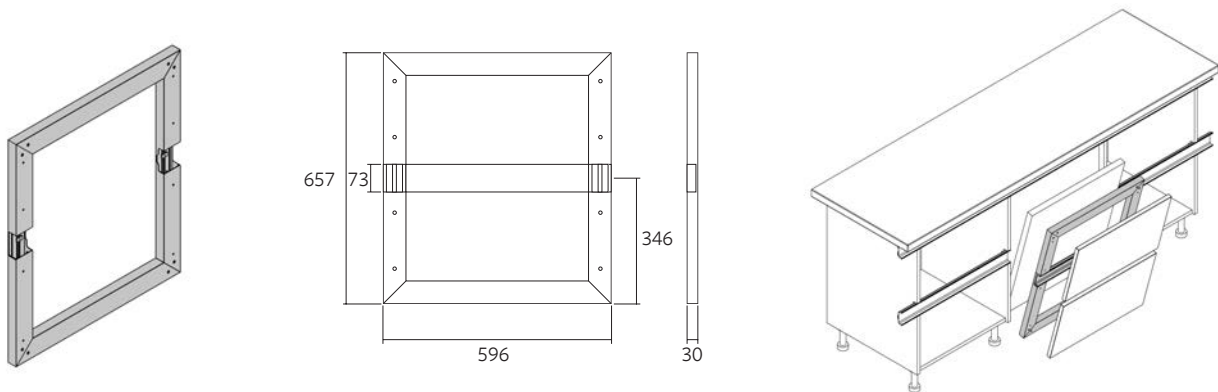

Code	Description
SGPDFS	Drawerline dishwasher frame

- This product is to allow for the continuation of a two or three drawer pack across the face of the dishwasher.
- It is recommended that a dishwasher with a height adjustment between 815-875mm is used.
- It is recommended that the plinth is set to 155mm to allow for clearance.
- Adjacent cabinets must be pulled forward by 30mm to align with the dishwasher unit.
- On installation it is recommended to pilot drill the frame to suit the screws provided with the dishwasher, or use self tapping screws.

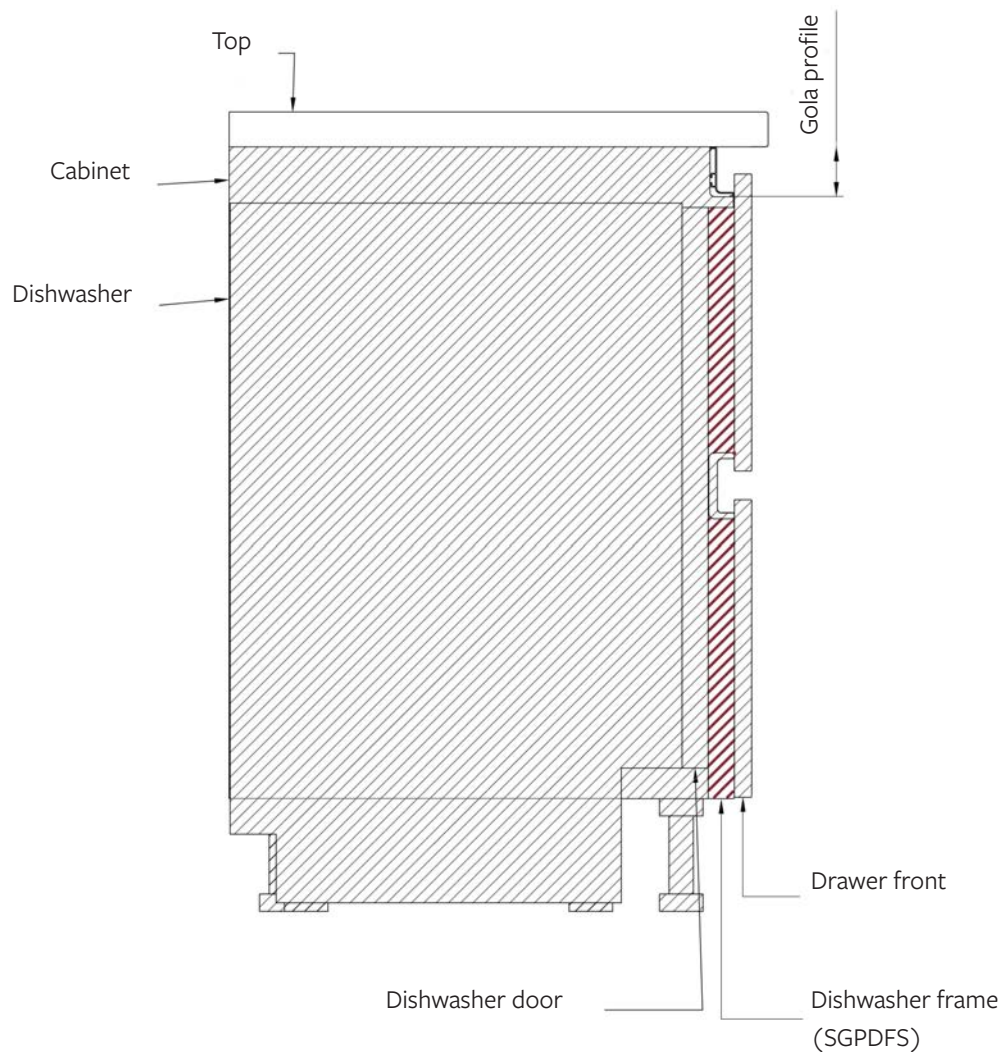

GOLA

Larder Rail

VERTICAL RAIL - SINGLE

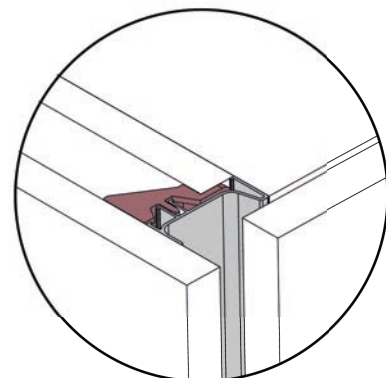
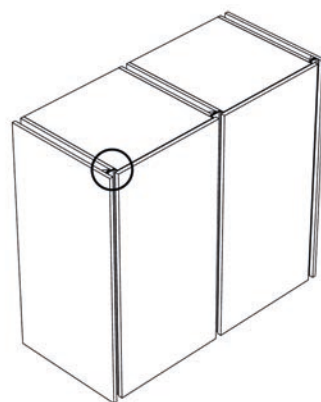
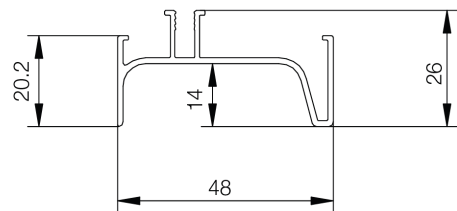

Code	Description
SGPC1(X)	Vertical rail - single, 4600mm
SGPC1.2300(X)	Vertical rail - single, 2300mm

- This product is for tall units.
- Secured to cabinets with fixing brackets.
Code: SGPCFIX2
- Cabinet gables must be reduced by 20mm
- Can be cut to size with a circular chop saw.

VERTICAL RAIL - DOUBLE

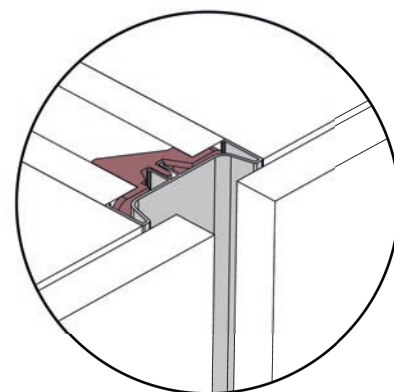
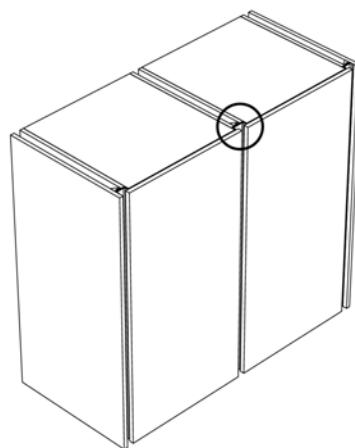
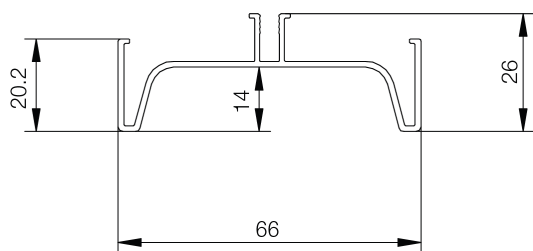

Code	Description
GPC2(X)	Vertical rail - double, 4600mm
GPC2.2300(X)	Vertical rail - double, 2300mm

- This product is for tall unit.
- Secured to cabinets with fixing brackets.
Code: SGPCFIX
- Cabinet gables must be reduced by 20mm
- Can be cut to size with a circular chop saw.

(X) Suffix required to specify colour

GOLA

Larder Rail

OVERVIEW

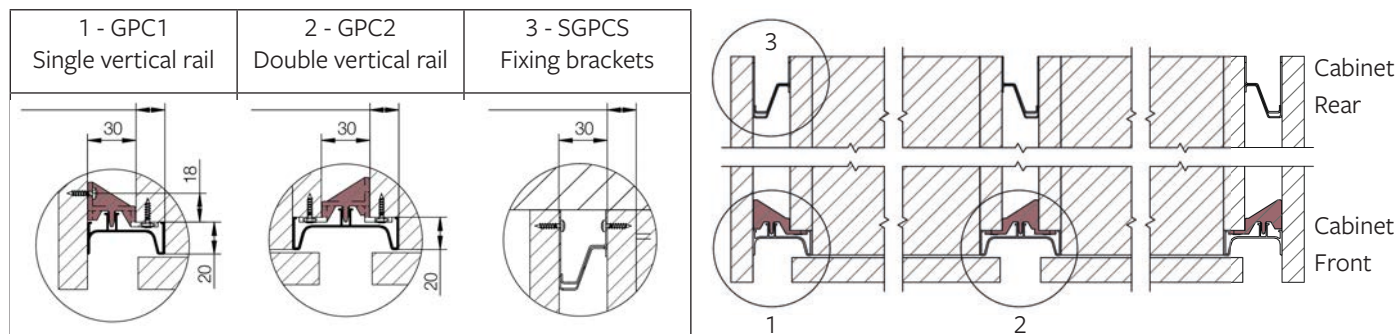

INSTALLATION

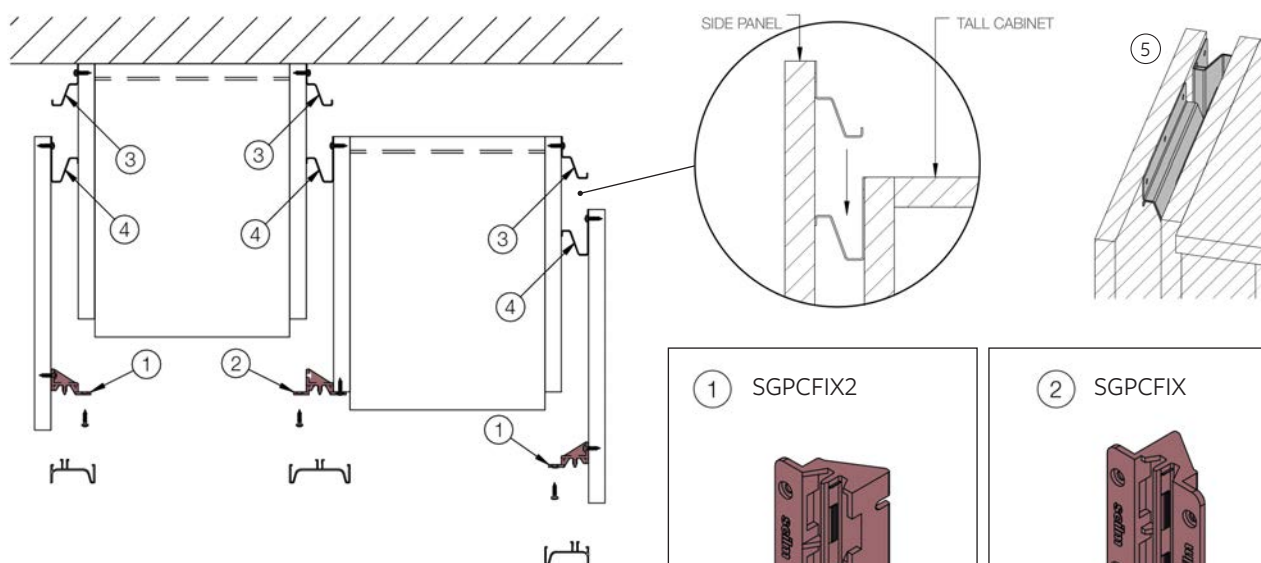

We recommend using wood screws, Ø 3.5, to fix brackets

1) Attach the fixing brackets (SGPCS) to the back edge of the cabinet (3) and side panel (4). Ensure they are flush with the back edge.

The rear bracket set can also be used as a support set for the side panel. In this case, it must be applied horizontally (5).

2) Secure the Gola fixing plates (1 & 2).

3) Place the side panels/cabinets into position.

4) Clip vertical rails into position.

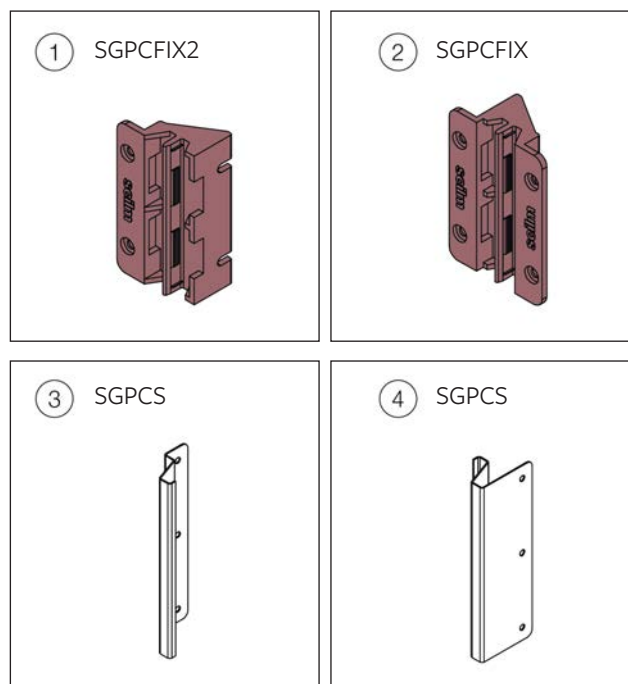

GOLA

Appliance Filler

APPLIANCE FILLER PROFILE

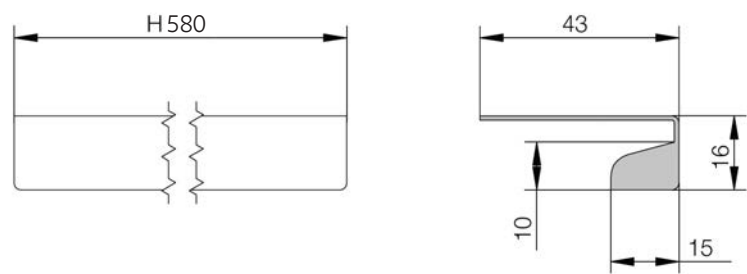

Code	Description
SGPCFILL580(X)	Appliance filler 580mm

- This product is for appliance fittings.
- Please note, for appliances less than 600mm high, there the filler will overhang.

GOLA

Appliance Filler

STEP 1

Fix filler in position with wood screws

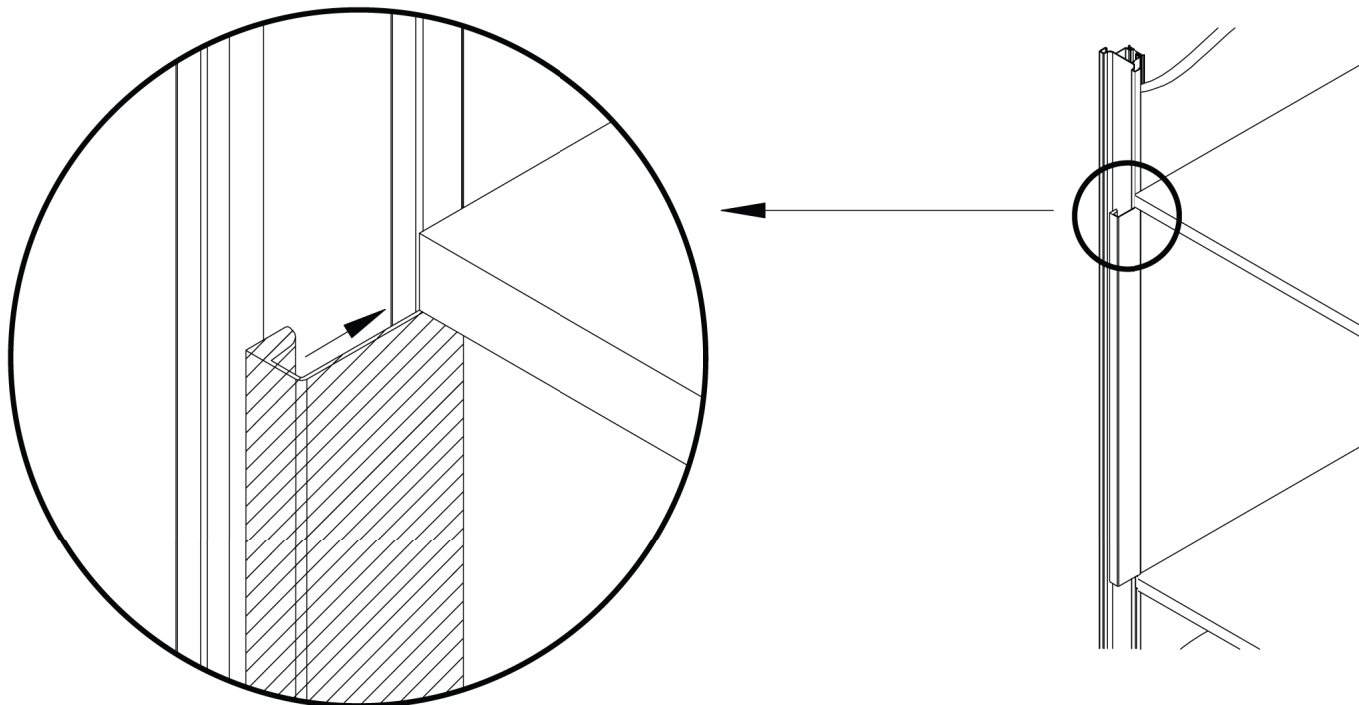

STEP 2

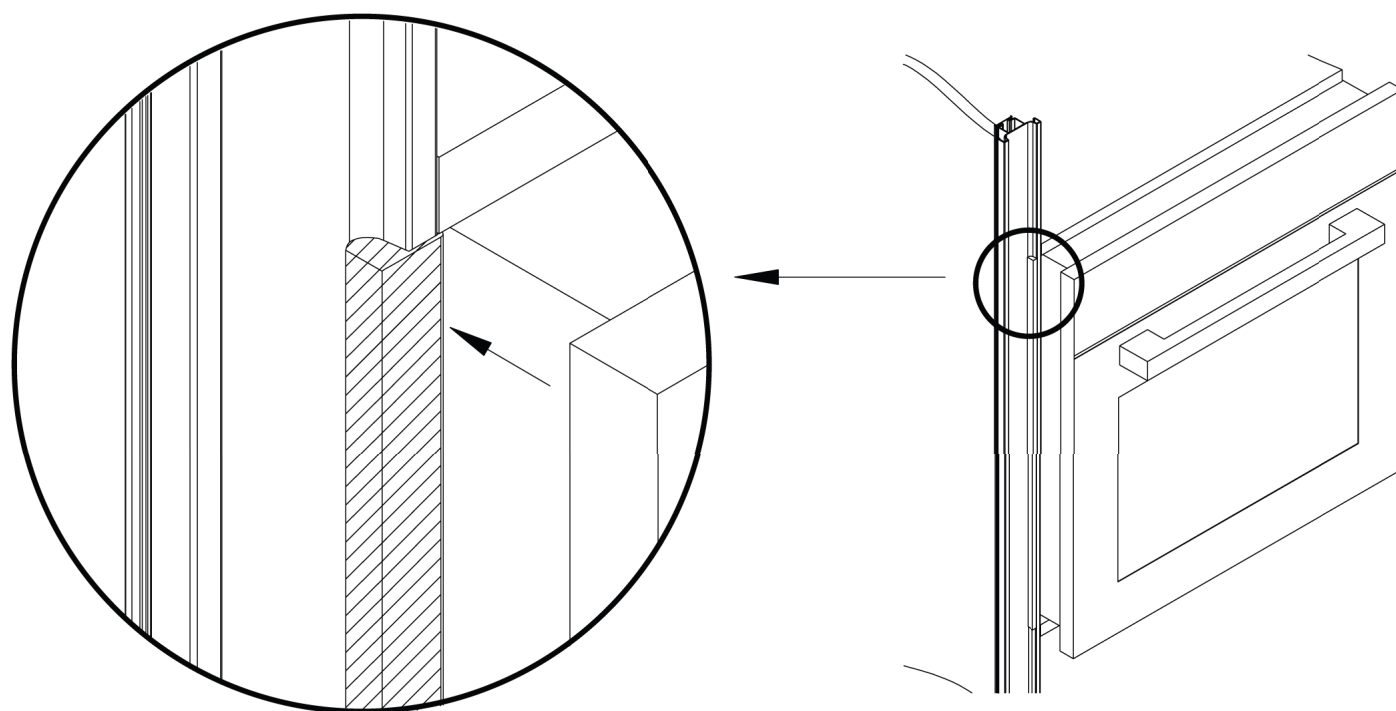

GOLA

Wall Rail

WALL RAIL OVERVIEW

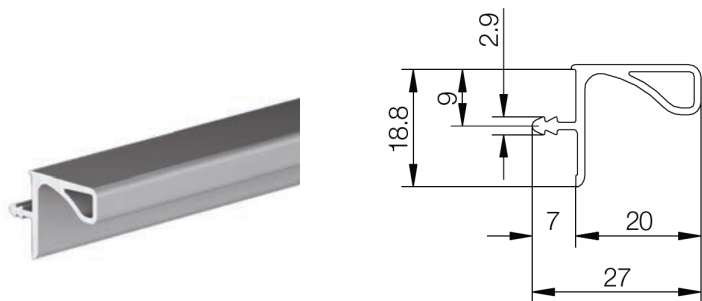

Code	Description
SGPWHP(X)	Wall rail 3900mm

- This product is for wall units.
- The base shelf of the wall cabinet requires a routed section to accommodate the rail.
- Can be cut to size with a circular chop saw.

(X) Suffix required to specify colour

INSTALLATION

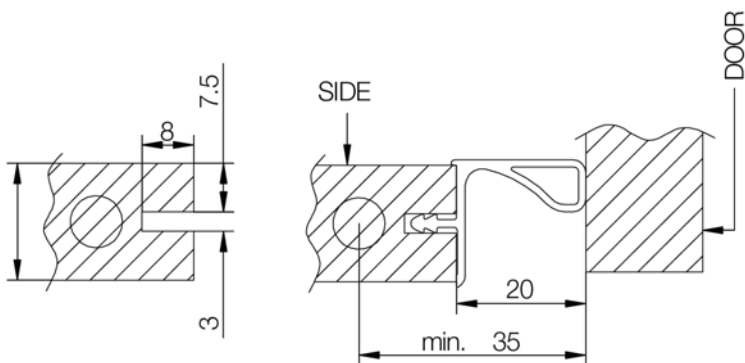

GOLA

Matrix

